

- **BUMPER—FRONT AND REAR—INSERT MOULDING BULGE**
- **EXTERIOR TRIM—BUMPER INSERT MOULDING BULGES**

**Article No.
90-22-4**

MERCURY: 1991 CAPRI

ISSUE

The bumper insert moulding may bulge at the outer ends of the bumper. This usually occurs between the end of the insert moulding and the #1 retaining tab or between the #1 retaining tab and other retaining tabs, Figure 1.

ACTION

Rework the existing bumper insert moulding or, if required, install new bumper insert mouldings. Refer to the following procedure for service details.

BUMPER MOULDING REWORK PROCEDURE

1. Remove the two (2) bumper side retaining screws from within the fender opening (either one or both sides as applicable), Figure 1. This will enable the bumper wings to be pulled away from the vehicle and allow access to the end of the insert moulding.
2. If the bulge is between the first retaining tab and the end of the bumper insert moulding, proceed as follows:
 - a. Inspect the insert moulding to see if it is contacting the inner flange of the bumper.
 - b. If the moulding is in contact with the flange, trim the moulding at an angle to provide clearance, Figure 2.
 - c. Inspect the insert moulding to be sure that the bulge has been removed.
 - d. If this rework does not correct the concern, replace the insert moulding. See the bumper insert replacement procedure in this article.
3. If the bulge is between the first and second or subsequent retaining tabs, proceed as follows.
 - a. Pull the insert moulding toward the bumper end until there is sufficient clearance to insert a 8-10mm wide wedge (cut from waste insert moulding) between the rear face of the #1 retaining tab and the rear edge of the retainer opening, Figure 3.
 - b. Insert an 8-10mm wide wedge into the opening.
 - c. Trim the end of the insert moulding to clear the bumper inner flange.
4. Replace the insert moulding if the bulge is between the first and second or subsequent retaining tabs and the tabs are against the outer end of the retainer opening, Figure 4. See the following bumper insert replacement procedure.

BUMPER INSERT MOULDING REPLACEMENT PROCEDURE

CAUTION

WHEN REMOVING THE BUMPER INSERT MOULDING, WITH THE BUMPER ON THE VEHICLE, MAKE SURE THAT THE BUMPER SLOTS USED TO RETAIN THE INSERT MOULDING ARE NOT DAMAGED. ALSO BE CAREFUL NOT TO DAMAGE THE PAINTED SURFACES.

REMOVAL

1. Beginning from tab #1, use a thin spatula or similar tool to gently spread the retainer opening on the inner face of the bumper to release the moulding retainer tab, Figure 5.
2. Grasp the end of the insert moulding and lightly pull it outward from the bumper.
3. Using the spatula from the outer surface of the bumper, carefully release each retaining tab from the bumper slots.
4. After all insert moulding retainers are disengaged from the bumper wings, pull the insert moulding outward from the the center retaining groove.

Article No. 90-22-4 Cont'd.

INSTALLATION

1. Place the replacement insert moulding centrally on the bumper, Figure 6.

NOTE

MAKE SURE THAT THE DIMENSION BETWEEN POINT A AND THE CENTER LINE OF THE MOULDING IS $500 \pm 2.0\text{MM}$.

2. Put the moulding into the retaining groove and press firmly until fully installed.
3. Route the insert to the bumper ends, engaging the retaining tabs into the apertures, Figure 7.
4. Pull the insert toward the bumper end and insert the wedges as done previously.
5. Inspect the insert moulding to be sure it does not contact the bumper inner flange.
6. Trim the moulding to clear the flange as required.
7. Install the bumper side retaining screws.

PART NUMBER	PART NAME
FOJY-17C829-A	Insert Moulding, Front Bumper
FOJY-17C830-A	Insert Moulding, Rear Bumper

OTHER APPLICABLE ARTICLES: None

WARRANTY STATUS: Eligible Under Basic Warranty Coverage

OPERATION	DESCRIPTION	TIME
902204A	Front Bumper Insert - Rework	0.4 Hr.
902204B	Rear Bumper Insert - Rework	0.4 Hr.
902204C	Rear Bumper Insert - Replace	0.7 Hr.
902204D	Front Bumper Insert - Replace	0.7 Hr.

DEALER CODING

BASIC PART NO.
17C830

OASIS CODES: 108000

CONDITION
CODE
02

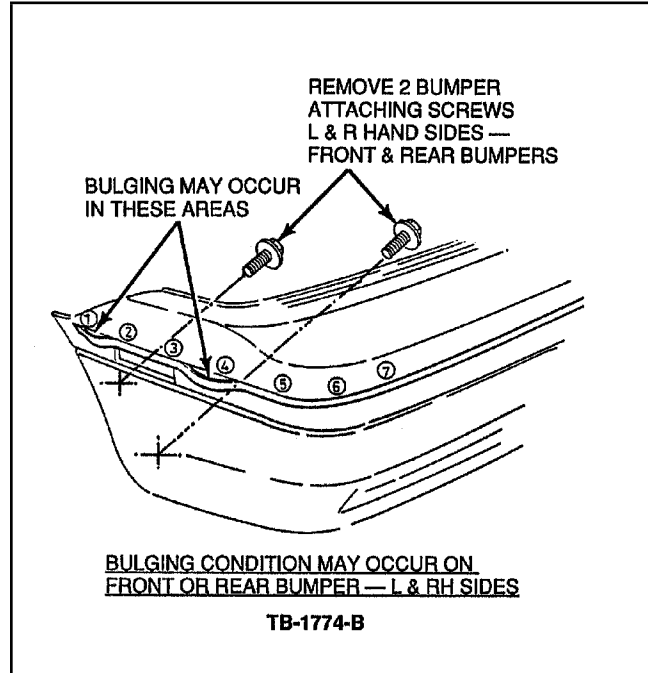

Figure 1 - Article 90-22-4

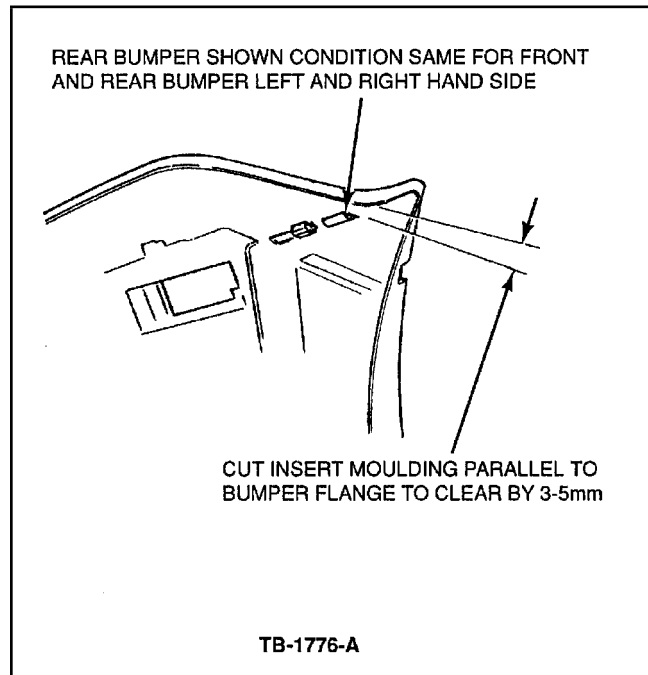

Figure 2 - Article 90-22-4

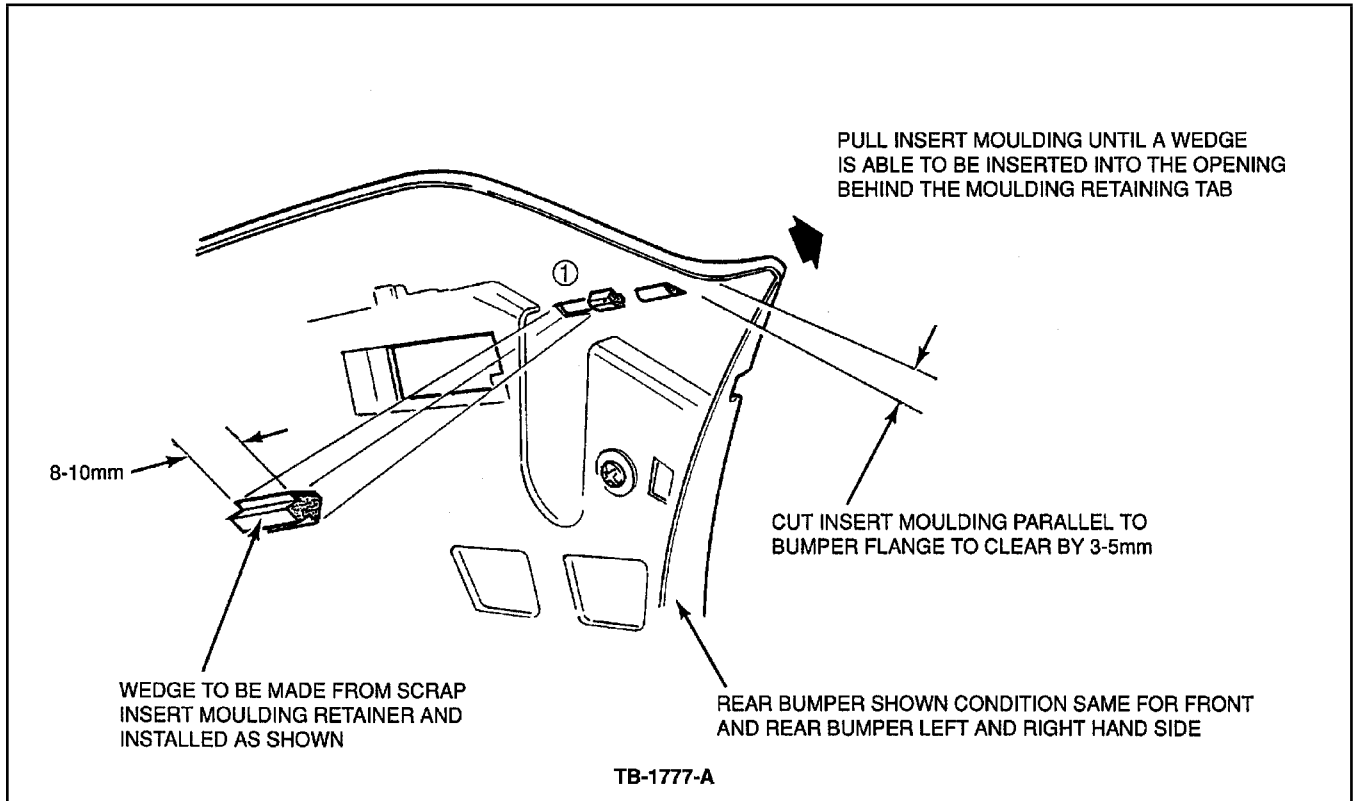

Figure 3 - Article 90-22-4

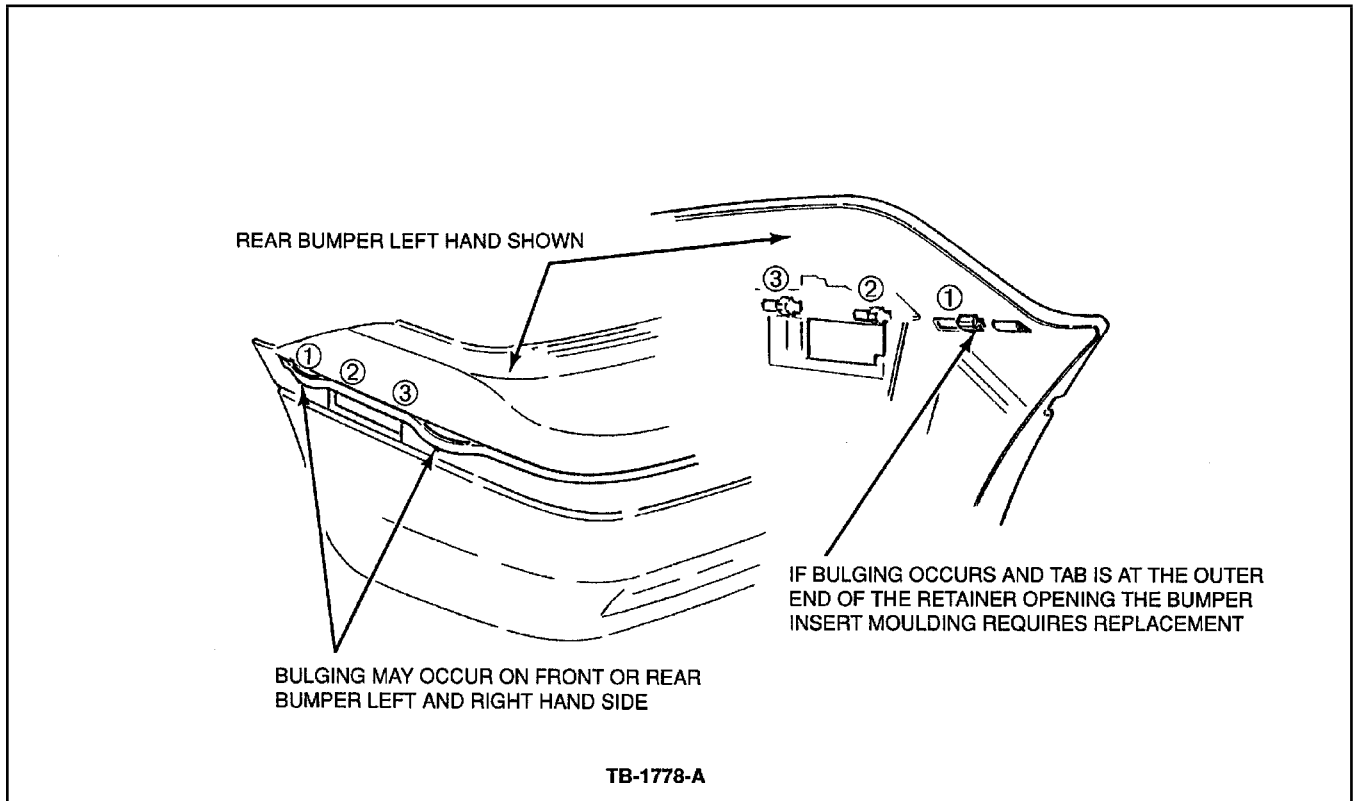

Figure 4 - Article 90-22-4

Article No. 90-22-4 Cont'd.

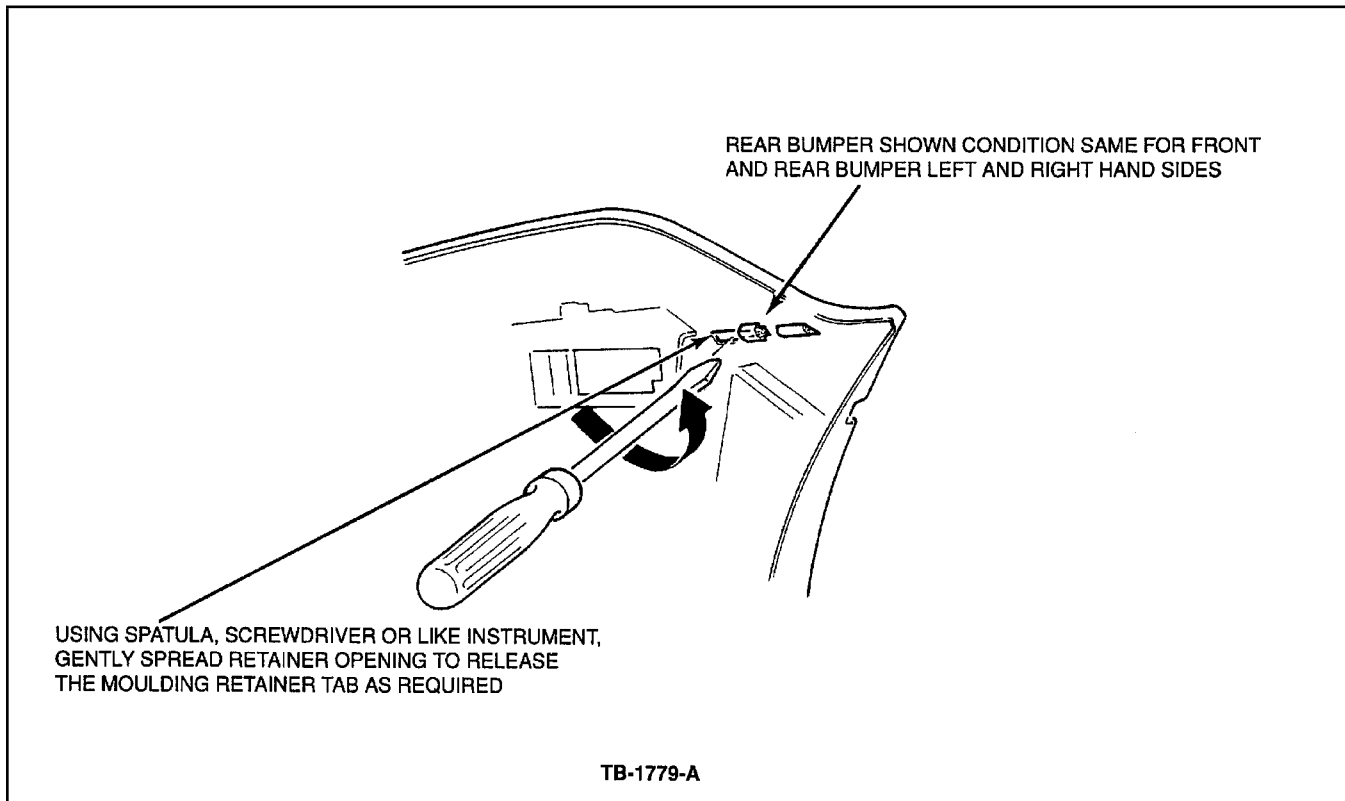

Figure 5 - Article 90-22-4

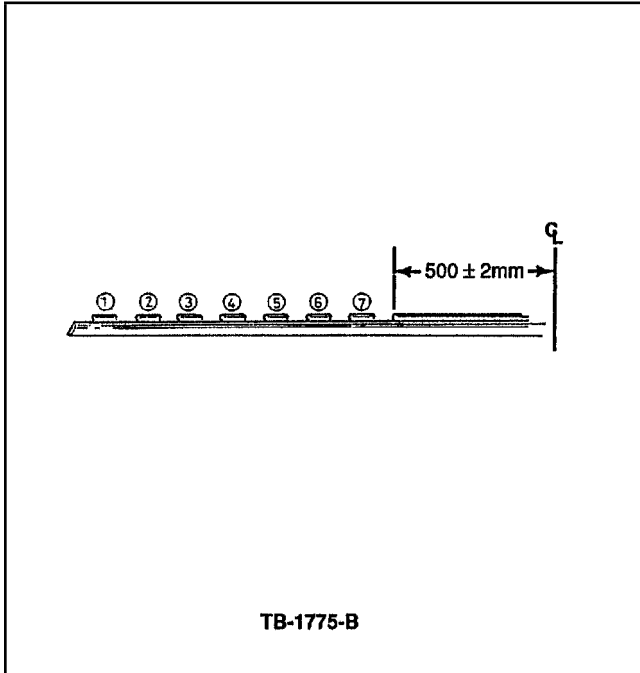

Figure 6 - Article 90-22-4

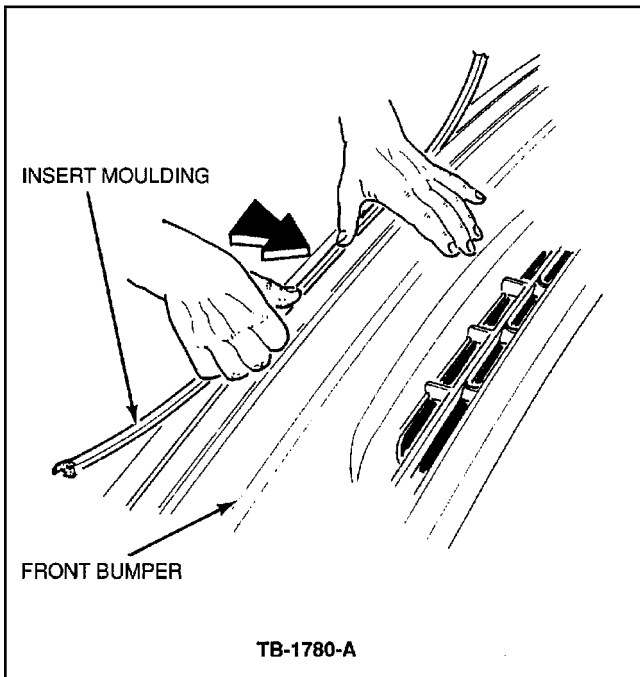

Figure 7 - Article 90-22-4